

NOTE:
IT IS THE RESPONSIBILITY OF THE
DESIGNER / END USER TO VERIFY THAT
STRUCTURES BUILT WITH ECO-BLOCK
HAVE BEEN DESIGNED, ENGINEERED, AND
CONSTRUCTED IN ACCORDANCE WITH ALL
APPLICABLE BUILDING CODES AND REGULATIONS

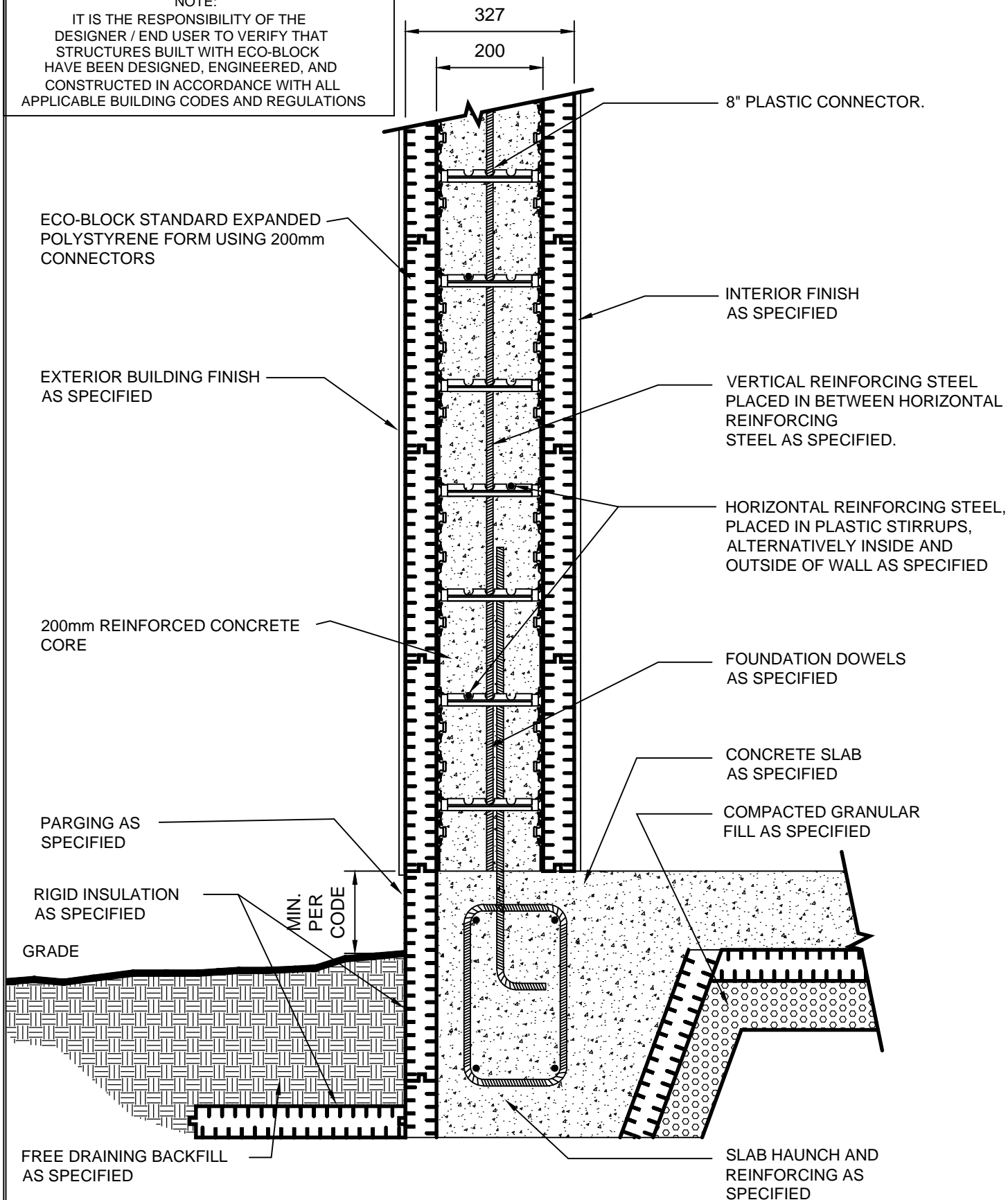

Eco-Block, NZ

ICF SOLUTIONS LTD.
PAUL JONES
FREE PHONE 0508 ECOICF (0508 326 423)
P.O. BOX 11
PAPAMOA 3151
WWW.ECOICF.CO.NZ

330mm Eco-Block System

**FOUNDATION DETAIL 3
200mm FORM BLOCK
ICF SOLUTIONS LIMITED**

DATE: 2.3.15

SCALE: 1:10

REVISION:

DRAWING NUMBER:

ECO-BLOCK-034